

PAREKH COPY

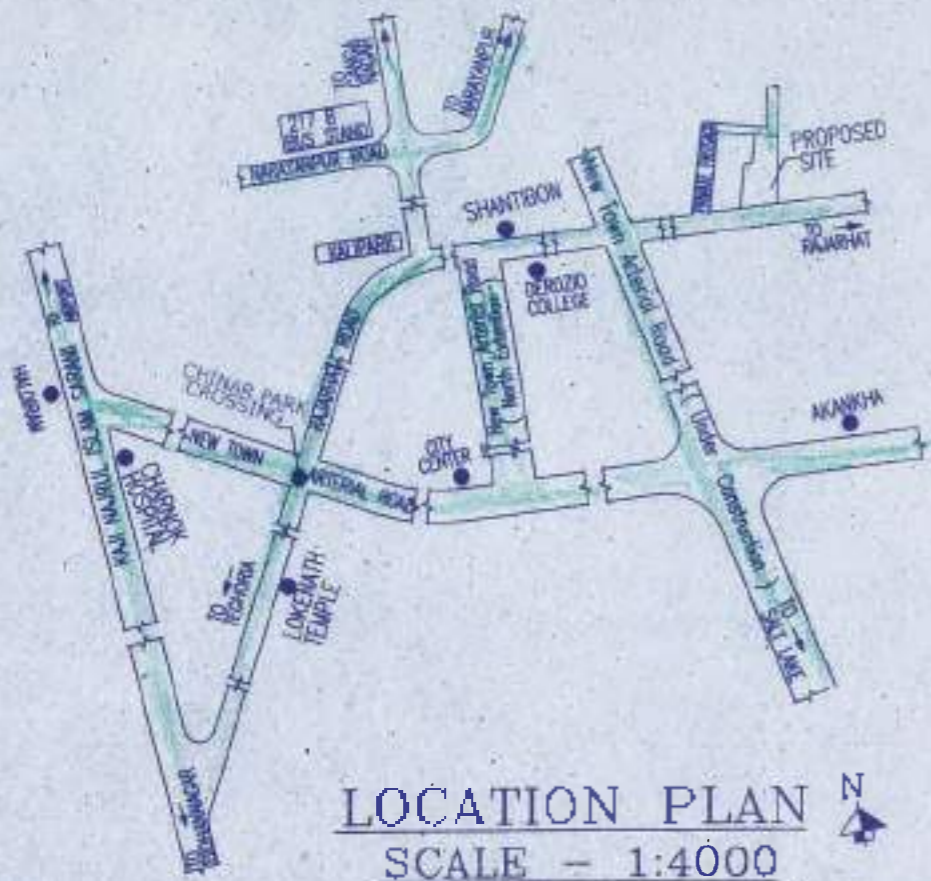

**LOCATION PLAN**  
SCALE - 1:4000

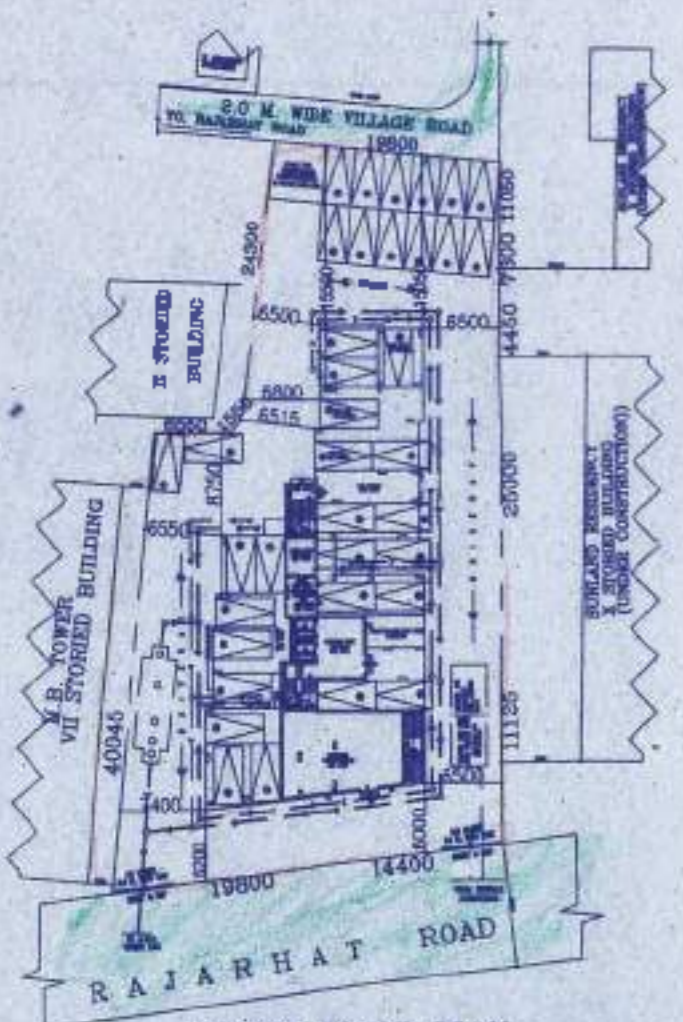

**GROUND FLOOR PLAN**  
SCALE - 1:600

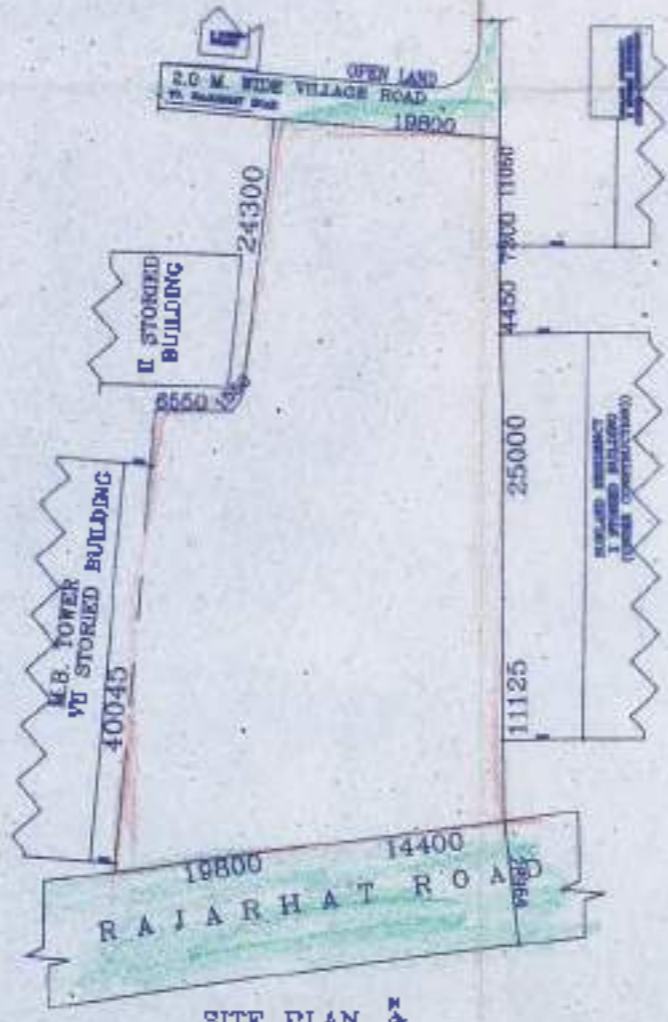

**SITE PLAN**  
SCALE - 1:600

SITE PLAN OF A PIECE OF LAND AT LR DAG NO.-3408, 3410, 3456 R.S./L.R. KHATIAN NO.-8226, 8227, 5511, 5512 IN MOUZA-GOPALPUR, J.L. NO.-2, R.S. NO - 140, TOUZI NO.-125B/1, P.S.-AIRPORT, UNDER BIDHANNAGAR MUNICIPAL CORPORATION, DISTRICT-NORTH 24 PARAGANAS.

**AREA STATEMENT**

LAND AREA (26K-COCH-00SFT.=18720 SF)	= 1739.130 SQM.
PERMISSIBLE F. A. R.	= 3.0
PERMISSIBLE GROUND COVERAGE (50%)	= 869.565 SQM.
PERMISSIBLE BUILT UP AREA	= 5217.39 SQM.

**CERTIFICATE**

THE SITE HAS BEEN INSPECTED PERSONALLY AND THE STRUCTURAL DESIGN INCLUDING THAT OF FOUNDATION HAS BEEN MADE ON THE BASIS OF RECOMMENDATIONS OR FINDINGS OF THE GEOTECHNICAL ENGINEER.

*R. D.*  
**Rajkumar Agarwal**  
Architect  
Member of Council of  
Architecture CA/94/17940  
\_\_\_\_\_  
SIG. OF ARCHITECT.

*[Signature]*  
**SANJIV J. PAREKH**  
M.F. ISTRUC., PCCGM, C. (ENG.)-1  
MSCE ASCE, AM 055212  
S.E-1771  
BIDHANNAGAR MUNICIPAL CORPORATION  
\_\_\_\_\_  
SIG. OF STRUCTURAL ENGINEER

*[Signature]*  
**DR. SUJIT KUMAR BOSF**  
Ph.D., M.C.E. (S&E), B.C.E. (Hons.)  
MGS, PIRC  
Empowered to Geotechnical  
Engineering  
\_\_\_\_\_  
SIG. OF GEOTECHNICAL ENGINEER